

Rotation Nozzle »MicroWhirly« Series 566 Stainless steel version

FDA-conform
See page 8.

Series 566

- Only 20 mm diameter to insert in small openings
- Excellent cleaning power
- Stainless steel AISI 316 L
- Durable PEEK Slide Bearing
- Slip-on pin mounting for 3/4" diameter tubing
- All used material (including slide bearing) are FDA-conform
- Very compact design
- Self rotating
- Driven and lubricated by the cleaning fluid

Applications:

- Cleaning of
- Kegs
 - Barrels
 - Cans
 - Autoclaves
 - Machines

Max. spray diameter:

1 – 1.5 m

Operating pressure:

1 – 2 bar

Max temperature:

140 °C

Installation:

Operation in every direction is possible

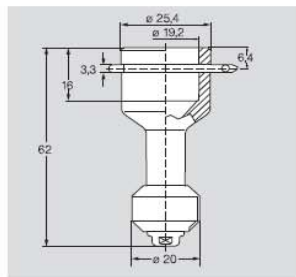

Slip-on connection
(incl. R-Clip, made of stainless steel AISI 316 L,
Ord. no. 095.022.1Y.50.94.E)

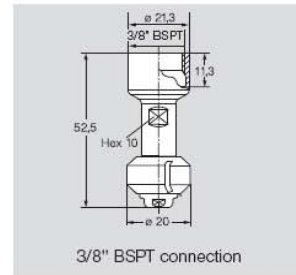
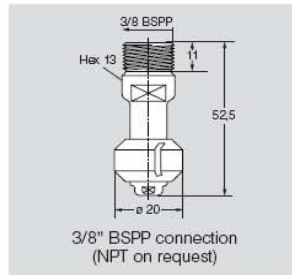

Spray-angle 	Ordering number Type	Connection			E Ø [mm]	Flow rate \dot{V} [l/min]			
		3/8" BSPP*	3/8" BSPT	Slip-on		Δp [bar]	($\Delta p_{max} = 6 \text{ bar}$)	40 psi [US gal./ min]	
180° 	566.873.1Y	AE	AF	TF	2.4	12	15	18	4.7
	566.933.1Y	AE	AF	TF	2.4	15	21	26	6.5
180° 	566.874.1Y	AE	AF	TF	2.4	12	15	18	4.7
	566.934.1Y	AE	AF	TF	2.4	15	21	26	6.5
360° 	566.879.1Y	AE	AF	TF	2.4	12	15	18	4.7
	566.939.1Y	AE	AF	TF	2.4	15	21	26	6.5

E = Narrowest free cross-section · * NPT on request

Please note: We do not recommend the operation with compressed air. Higher pressure generally means higher wear and smaller droplets. This might have adverse effects on the cleaning result. For further ordering data please turn to your Lechler contact person. In order to protect the bearing a line-strainer with a mesh size of 0.3 mm/50 mesh is recommended.

Example **Type** + **Connection** = **Ordering no.**
for ordering: 566.873.1Y.XX + AE = 566.873.1Y.AE